

## ΔΙΚΛΕΙΔΕΣ ΠΕΤΑΛΟΥΔΑΣ ΜΕ ΑΥΛΑΤΩΤΑ ΑΚΡΑ

4649xxA 1/1

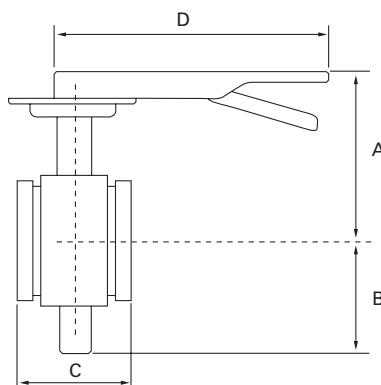

FIG. 8200



Tyco BSP Article Number	Nominal Size	Pipe OD mm	Max. Wk Pressure Bar Psi	A	B	C	D	Approx Weight Kg
	mm Inches			mm	mm	mm	mm	
8200-060	50 2	60.3	20.7 300	119.1	86.2	86.2	254.0	1.9
8200-073	65 2 1/2	73.0	20.7 300	125.0	96.3	96.3	254.0	2.9
8200-076	65 2 1/2	76.1	20.7 300	125.0	96.3	96.3	254.0	2.9
8200-089	80 3	88.9	20.7 300	131.8	96.3	96.3	254.0	3.4
8200-114	100 4	114.3	20.7 300	164.8	115.3	115.3	254.0	5.3
8200-139	125 5	139.7	20.7 300	195.3	132.3	132.3	283.0	7.6
8200-141	125 5	141.3	20.7 300	195.3	132.3	132.3	283.0	7.6
8200-165	150 6	165.1	20.7 300	208.8	144.8	144.8	283.0	12.1
8200-168	150 6	168.3	20.7 300	208.8	144.8	144.8	283.0	12.1
8200-219	200 8	219.1	20.7 300	255.2	165.4	147.4	355.6	14.7

Note: maximum working temperature 110° C (230° F)  
recommended for mounting with Grinnell Rigid couplings

General notes: It is the Designer's responsibility to select products suitable for the intended service and to ensure that pressure ratings and performance data is not exceeded. Always read and understand the installation constructions. Never remove any piping components nor correct or modify any piping deficiencies without first depressurizing and draining the system. Material and seat selection should be verified to be compatible for the specific application.

## MATERIAL SPECIFICATION

**Body:** Ductile iron - Epoxy Coated  
**Disc:** Ductile iron / EPDM

**Shaft:** Stainless Steel

TYCENMECH-7/04 Tyco reserves the right to change the contents without notice